



# Dovetail RUGGED TOUCH DISPLAY

[www.dandrelectronics.com](http://www.dandrelectronics.com)



## KEY FEATURES:

**ENABLE DEX IN TWO WAYS. THROUGH A USB TYPE C CONNECTION AND/OR THROUGH AN HDMI CONNECTION FROM THE MONITOR TO THE DOVETAIL BREAKOUT BOX**

**LARGE 12.25"/311.15 MM HD 1080P, 1200 NIT TOUCH DISPLAY**

**PHYSICAL KEYS TO EASILY ADJUST BRIGHTNESS/ VOLUME**

**AMBIENT SENSOR TO ADJUST BRIGHTNESS AUTOMATICALLY**

**OPTIMIZED AUDIO EXPERIENCE WITH TWO 3.0W INTEGRATED SPEAKER**

**MIL SPEC RATING: MIL-810G, WITH OPERATING TEMPERATURE -20°C =/-4°F TO +60°C/140°F**

# Dovetail TECHNICAL SPECS.

		RuggON MP Version
Display	Size	11.6"
	Resolution	1920 (H) *RGB* 1080 (V)
	Brightness	1000nits
	Contrast Ratio	900 :1 Typ.
	Response time	25 ms (50ms max)
	Color Depth	
	View Angle	85/85/85/85 (80/80/80/80 min)
	Operation Temperature	-20~70
Touch	Type	P-CAP
	#of Points	Multi-Point
	CG	True-Flat
	Optional Coating	AF/AR
Power Input	Voltage	12V
	Connector	DC Jack w/ screw
Video input	HDMI 1.4	X1
	USB Type C	x1
External I/O	USB Type A	USB 2.0 x1 (upward with cover) USB 2.0 x4 (downward)
	USB Type B	x1
Button	Physical	Total x7 Auto dimming on/off x1 Brightness x2 Black out x1 Volumex1
Others	Speaker	3W x2
	Ambient Light Sensor	Yes
	Mounting	VESA 75 (* M5 screw hole)
	Accessories (Optional)	Cable lock bracket
System Environmental Spec	Shock/ Vibration	MIL-810G
Outlook	Operation Temperature	-20 ~60
	Dimension	332x 268x 43 (mm)
	Material	Plastic

**For more information on this and other products, please contact:**

**D&R Electronics Co. Ltd.**

**Toll Free: 1-800-538-7338**

**[www.dandrelectronics.com](http://www.dandrelectronics.com)**



**Dovetail** PHONE CASES  
FOR SAMSUNG GALAXY LINE



8820 George Bolton Parkway, Bolton, Ontario, L7E 2Y4 Canada  
Tel: (905) 951-9997 / Fax: (905) 951-0019 Toll Free: 1-800-538-7338  
[www.dandrelectronics.com](http://www.dandrelectronics.com)

**D&R**  
**Dovetail**  
[www.dandrelectronics.com](http://www.dandrelectronics.com)



**CREATE A  
DESKTOP  
EXPERIENCE  
USING  
DOVETAIL**

## Dovetail VEHICLE DOCKING SOLUTION

DOVETAIL IS A UNIVERSAL MOUNTING SOLUTION SUPPORTING THE CHANGING GALAXY SMART PHONE ENVIRONMENT.

A MOUNTING SOLUTION THAT ENABLES DOCKING VARIOUS MODELS OF GALAXY SMARTPHONES, WITHOUT MODIFICATIONS

CONNECT UP TO SIX USB ACCESSORIES AND A MONITOR

PROVIDES CHARGING TO SMARTPHONES



## Dovetail DESKTOP DOCKING SOLUTION

ENJOY A VIVID VIDEO EXPERIENCE

HD+, FHD, AND WQ HD RESOLUTIONS

USB PORTS

CHANGE THE DEFAULT SPEAKERS FROM YOUR MOBILE DEVICE'S SPEAKERS TO THE SPEAKERS OF ATV, MONITOR, OR AN AUDIO DEVICE

DUAL SCREEN DISPLAY



## Dovetail RUGGED TOUCH DISPLAY

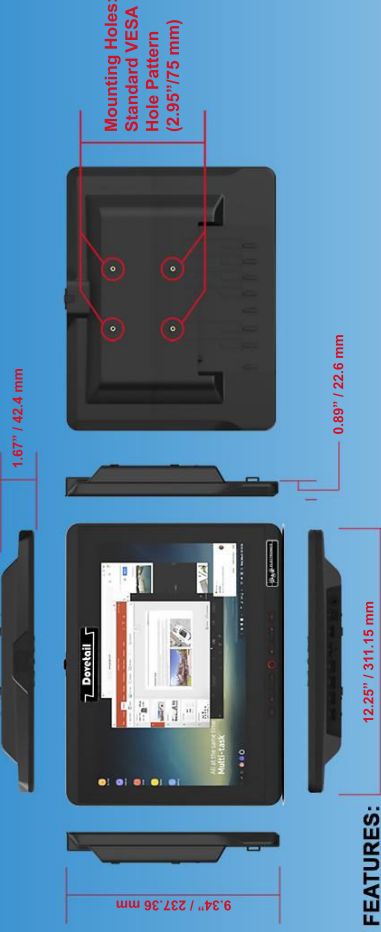

### KEY FEATURES:

ENABLE DEX IN TWO WAYS. THROUGH A USB TYPE C CONNECTION AND/OR THROUGH AN HDMI CONNECTION FROM THE MONITOR TO THE DOVETAIL BREAKOUT BOX

LARGE 12.25"/311.15 MM HD 1080P, 1200 NIT TOUCH DISPLAY

PHYSICAL KEYS TO EASILY ADJUST BRIGHTNESS/ VOLUME

AMBIENT SENSOR TO ADJUST BRIGHTNESS AUTOMATICALLY

OPTIMIZED AUDIO EXPERIENCE WITH TWO 3.0W INTEGRATED SPEAKER

MIL SPEC RATING: MIL-810G, WITH OPERATING TEMPERATURE -20°C =/-4°F TO +60°C/140°F

## Dovetail RUGGEDIZED KEYBOARD

